

7'x4'x5' (ID) VAULT WITH FLOOR

SS120-50704 F
L0805-3636 R

PRODUCT INFORMATION

7'x4'x5' (ID)

UTILITY VAULT

VAULT = 11,900 #

LID = 2,400 #

*design may vary

SPECIFICATIONS

MEETS ASTM C858 & C857

RATING: NON-TRAFFIC

CONCRETE TO BE 4,000 PSI
@ 28 DAYS

REINFORCING STEEL MEETS
ASTM A 615

10" STEPS ON 12" CENTERS

BUTYL SEALANT MEETING ASTM
C 990 TO BE USED ON JOINTS

ACCESS HATCH SHALL BE
FABRICATED WITH 1/4"
ALUMINUM DIAMOND PLATE
DESIGNED TO SUPPORT 300 psf
36"x36" FRAME OPENING
EQUIPPED WITH: SLAM LOCK,
PUSH MOUNT LIFT HANDLE,
HOLD-OPEN ARM, SS HARDWARE
AND HINGES

PENETRATIONS SIZE AND
LOCATION VARY PER JOB

CALL FOR ADDITIONAL SPECS



DRAWING INFORMATION

Drawn By: JIG

Checked By: CBC

Revision: 1

Date: 11/23/16

APPROVED BY: _____

print: _____

sign: _____

*actual dimensions may vary slightly

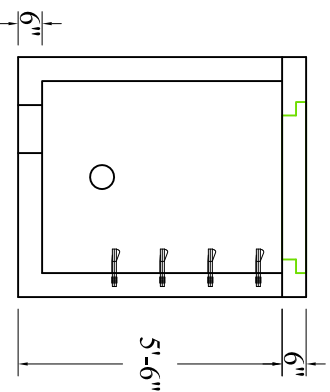
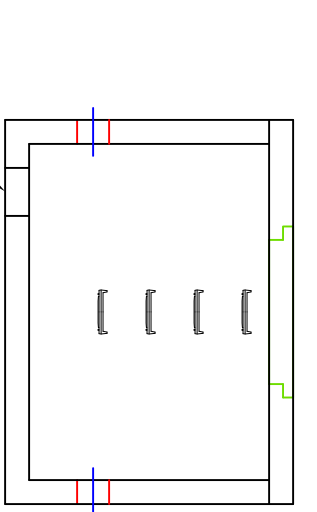
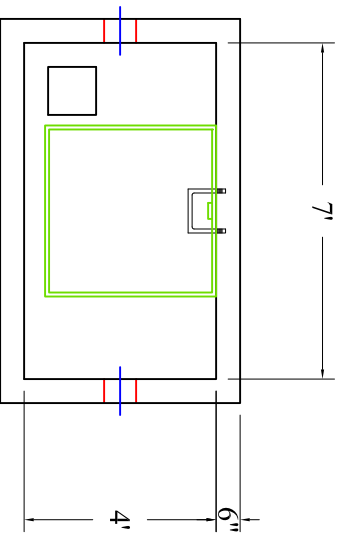

Scale: 1/4" = 1'



BARTOW PRECAST

770.382.4462
sales@bartowprecast.com
WWW.BARTOWPRECAST.COM