



Sealant Placement Checklist

Follow procedures for optimum sealant performance:

CS-102B (rope-type sealant)

- ✓ Clean upper and lower precast joint surface.
- ✓ Remove any dirt, debris, flashing, or concrete high points which could keep the joint from coming together.
- ✓ Place sealant on the joint (Figure 1). **DO NOT PLACE ANY SEALANT UNIONS WITHIN 12" OF A CORNER.**
- ✓ Join the sealant into one continuous strand by kneading (Figure 2) the ends together where they meet. **DO NOT STRETCH THE SEALANT. DO NOT OVERLAP THE SEALANT.**

Figure 1

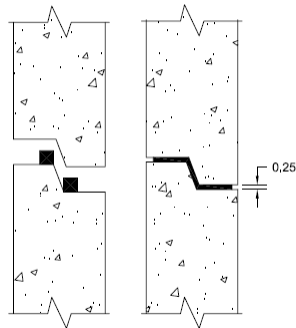
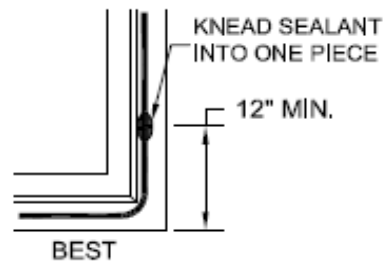

Figure 2



- ✓ Once the sealant is installed, do not:
 - Step on sealant
 - Allow dirt or debris to fall on the sealant

CS-212 (Flat, wrap-type sealant)

- ✓ Apply Conwrap to the external horizontal (mid-seam) joint, begin by removing the release paper from the adhesive side and applying Conwrap to the structure. Continue around the joint by removing the release paper as the Conwrap is unrolled allowing a 2" overlap at Conwrap union. Press the wrap firmly by hand against the entire surface as it is applied to assure full contact.

*For more information visit: www.conseal.com